

Limit switches

XC Standard range

Compact design, plastic, XCKP and XCKT

Compact design, metal, XCKD

■ XCKP, XCKD

with 1 cable entry

Conforming to CENELEC EN 50047

□ With head for linear movement (plunger). Fixing by the head or by the body

XCKD

XCKP

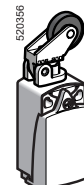

Pages 80 and 84

Pages 74 and 78

□ With head for rotary movement (lever) or multi-directional. Fixing by the body

XCKD

XCKP

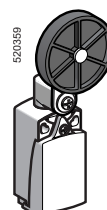
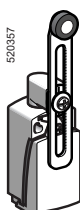

Pages 81 and 85

Pages 75 and 79

■ XCKT

with 2 cable entries

Tripping/resetting points and fixing centres conform to CENELEC EN 50047

□ With head for linear movement (plunger). Fixing by the head or by the body

XCKT

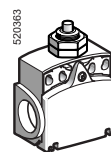
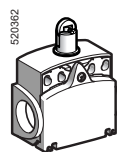
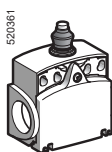

Page 86

□ With head for rotary movement (lever) or multi-directional. Fixing by the body

XCKT

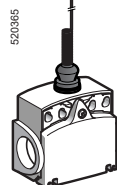
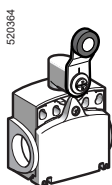

Page 86

Environment characteristics

| | | |
|---------------------------|------------------------------|--|
| Conformity to standards | Products | IEC 60947-5-1, EN 60947-5-1, UL 508, CSA C22-2 n° 14 |
| | Machine assemblies | IEC 60204-1, EN 60204-1 |
| Product certifications | | UL, CSA, CCC |
| Protective treatment | Standard version | "TC" |
| Ambient air temperature | For operation | - 25...+ 70°C (- 40...+ 70 °C with ZCE106, ZCE026 and ZCE016 heads) |
| | For storage | - 40...+ 70°C |
| Vibration resistance | Conforming to IEC 60068-2-6 | 25 gn (10...500 Hz) except product with head ZCE24: 20 gn |
| Shock resistance | Conforming to IEC 60068-2-27 | 50 gn (11 ms) except head ZCE08: 15 gn (11 ms) and ZCE24: 30 gn (18 ms) |
| Electric shock protection | | Class II conforming to IEC 61140 and NF C 20-030 for XCKP and XCKT Class I conforming to IEC 61140 and NF C 20-030 for XCKD |
| Degree of protection | | IP 66 and IP 67 conforming to IEC 60529; IK 04 conforming to IEC 62262 for XCKP and XCKT, IK 06 conforming to IEC 62262 for XCKD |
| Repeat accuracy | | 0.1 mm on the tripping points, with 1 million operating cycles for head with end plunger |
| Cable entry or connector | Depending on model | Either tapped entry for n° 11 or n° 13 cable gland, tapped ISO M16 x 1.5 or ISO M20 x 1.5, tapped 1/2" NPT or PF 1/2 (G1/2) or M12 connector |
| Materials | | XCKD Zamak bodies and heads, XCKP and XCKT plastic bodies, Zamak heads |

Limit switches

XC Standard range

Compact design, plastic, XCKP and XCKT
Compact design, metal, XCKD

| Contact block characteristics | | |
|---|-------------------------|--|
| Rated operational characteristics | XE2●P | ~ AC-15; A300 (Ue = 240 V, Ie = 3 A); Ithe = 10 A --- DC-13; Q300 (Ue = 250 V, Ie = 0.27 A), conforming to IEC 60947-5-1 Appendix A, EN 60947-5-1 |
| | XE3●P | ~ AC-15; B300 (Ue = 240 V, Ie = 1.5 A); Ithe = 6 A --- DC-13; R300 (Ue = 250 V, Ie = 0.1 A), conforming to IEC 60947-5-1 Appendix A, EN 60947-5-1 |
| Rated insulation voltage | XE2●P | Ui = 500 V degree of pollution 3 conforming to IEC 60947-1 Ui = 300 V conforming to UL 508, CSA C22-2 n° 14 |
| | XE3●P | Ui = 400 V degree of pollution 3 conforming to IEC 60947-1 Ui = 300 V conforming to UL 508, CSA C22-2 n° 14 |
| Rated impulse withstand voltage | XE2●P | U imp = 6 kV conforming to IEC 60947-1, IEC 60664 |
| | XE3●P | U imp = 4 kV conforming to IEC 60947-1, IEC 60664 |
| Positive operation (depending on model) | | NC contacts with positive opening operation conforming to IEC 60947-5-1 Appendix K, EN 60947-5-1 |
| Resistance across terminals | | ≤ 25 mΩ conforming to IEC 60255-7 category 3 |
| Short-circuit protection | XE2●P | 10 A cartridge fuse type gG (gl) |
| | XE3●P | 6 A cartridge fuse type gG (gl) |
| Connection (screw clamp terminals) | XE2SP●151 and XE2SP2141 | Clamping capacity, min: 1 x 0.34 mm ² , max: 2 x 1.5 mm ² |
| | XE2NP21●1 and XE2NP31●1 | Clamping capacity, min: 1 x 0.5 mm ² , max: 2 x 2.5 mm ² |
| | XE3NP and XE3SP | Clamping capacity, min: 1 x 0.34 mm ² , max: 1 x 1 mm ² or 2 x 0.75 mm ² |
| Minimum actuation speed (for head with end plunger) | | XE2SP●151, XE2SP2141 and XE3SP: 0.01 m/minute |
| | | XE2NP21●1, XE2NP31●1 and XE3NP: 6 m/minute |
| Electrical durability | | <ul style="list-style-type: none"> ■ Conforming to IEC 60947-5-1 Appendix C ■ Utilisation categories AC-15 and DC-13 ■ Maximum operating rate: 3600 operating cycles/hour ■ Load factor: 0.5 |

AC supply
50/60 Hz ~
mm. inductive circuit

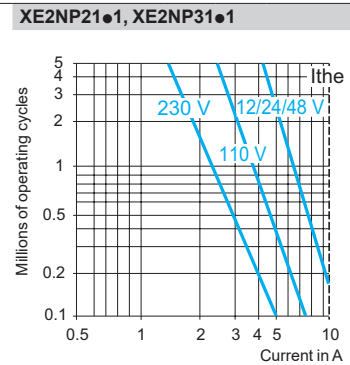
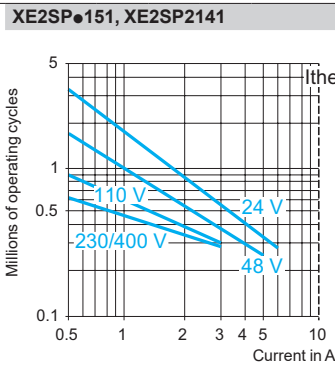

DC supply ---

Power broken in W for 5 million operating cycles.

| Voltage V | 24 | 48 | 120 |
|-----------|----|----|-----|
| mm. W | 10 | 7 | 4 |

Power broken in W for 5 million operating cycles.

| Voltage V | 24 | 48 | 120 |
|-----------|----|----|-----|
| mm. W | 13 | 9 | 7 |

For XE2SP●151 on ~ or ---, NC and NO contacts simultaneously loaded to the values shown with reverse polarity.

AC supply
50/60 Hz ~
mm. inductive circuit

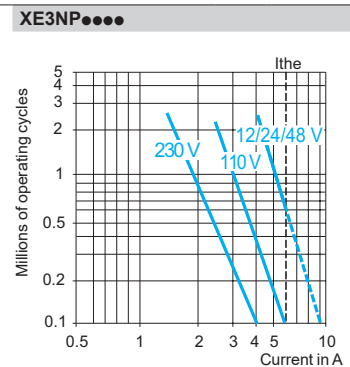
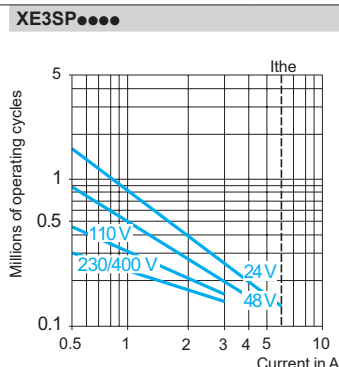

DC supply ---

Power broken in W for 5 million operating cycles.

| Voltage V | 24 | 48 | 120 |
|-----------|----|----|-----|
| mm. W | 3 | 2 | 1 |

Power broken in W for 5 million operating cycles.

| Voltage V | 24 | 48 | 120 |
|-----------|----|----|-----|
| mm. W | 4 | 3 | 2 |

Limit switches

XC Standard range

Compact design, plastic, XCKP
Complete switches with 1 cable entry

| Type of head | Plunger (fixing by the body) | | | | | |
|------------------|------------------------------|---------------------------------------|----------------------|---|---|--|
| | Form B (1) | | Form C (1) | | Form E (1) | |
| | | | | | | |
| Type of operator | Metal end plunger | Metal end plunger with elastomer boot | Steel roller plunger | Thermoplastic roller lever plunger, horizontal actuation in 1 direction | Thermoplastic roller lever plunger, vertical actuation in 1 direction | Thermoplastic roller lever plunger, horiz. or vert. actuation in 1 direction |

| References of complete switches with 1 ISO M16 x 1.5 cable entry (2) | | | | | | | |
|--|---|-----------------------------|-----------------------------|-----------------------------|-----------------------------|-----------------------------|-----------------------------|
| | 2-pole NC + NO snap action (XE2SP2151) | XCKP2110P16 | XCKP2111P16 | XCKP2102P16 | XCKP2121P16 | XCKP2127P16 | XCKP2128P16 |
| | 2-pole NC + NO break before make, slow break (XE2NP2151) | XCKP2510P16 | XCKP2511P16 | XCKP2502P16 | XCKP2521P16 | XCKP2527P16 | XCKP2528P16 |
| | 2-pole NC + NC snap action (XE2SP2141) | ZCP29 + ZCPEP16 + ZCE10 | ZCP29 + ZCPEP16 + ZCE11 | ZCP29 + ZCPEP16 + ZCE02 | ZCP29 + ZCPEP16 + ZCE21 | ZCP29 + ZCPEP16 + ZCE27 | ZCP29 + ZCPEP16 + ZCE28 |
| | 2-pole NC + NC simultaneous, slow break (XE2NP2141) | ZCP27 + ZCPEP16 + ZCE10 | ZCP27 + ZCPEP16 + ZCE11 | ZCP27 + ZCPEP16 + ZCE02 | ZCP27 + ZCPEP16 + ZCE21 | ZCP27 + ZCPEP16 + ZCE27 | ZCP27 + ZCPEP16 + ZCE28 |
| | 3-pole NC + NC + NO snap action (XE3SP2141) | ZCP39 + ZCPEP16 + ZCE10 | ZCP39 + ZCPEP16 + ZCE11 | ZCP39 + ZCPEP16 + ZCE02 | ZCP39 + ZCPEP16 + ZCE21 | ZCP39 + ZCPEP16 + ZCE27 | ZCP39 + ZCPEP16 + ZCE28 |
| | 3-pole NC + NC + NO break before make, slow break (XE3NP2141) | ZCP37 + ZCPEP16 + ZCE10 | ZCP37 + ZCPEP16 + ZCE11 | ZCP37 + ZCPEP16 + ZCE02 | ZCP37 + ZCPEP16 + ZCE21 | ZCP37 + ZCPEP16 + ZCE27 | ZCP37 + ZCPEP16 + ZCE28 |
| Weight (kg) | 0.090 | 0.090 | 0.095 | 0.105 | 0.100 | 0.105 | |

References of complete switches with 1 entry for n° 11 cable gland

For an entry tapped for a n° 11 cable gland, replace P16 in the reference by G11. Example: XCKP2110P16 becomes XCKP2110G11 or ZCPEP16 becomes ZCEG11.

| | | | |
|-------------------|----------------|--|--|
| Contact operation | closed open | (A) (B) = cam displacement (P) = positive opening point | NC contact with positive opening operation |
|-------------------|----------------|--|--|

| Characteristics | |
|---|--|
| Switch actuation | On end By 30° cam |
| Type of actuation | |
| Maximum actuation speed | 0.5 m/s 1 m/s |
| Mechanical durability (in millions of operating cycles) | 15 10 |
| Minimum force or torque | For tripping 15 N 12 N 6 N |
| | For positive opening 45 N 36 N 18 N |
| Cable entry (3) | 1 entry tapped M16 x 1.5 mm for ISO cable gland, clamping capacity 4 to 8 mm |

(1) Form conforming to EN 50047, see page 24.

(2) Switches with gold contacts or eyelet type connections: please consult our Customer Care Centre.

Limit switches

XC Standard range
Compact design, plastic, XCKP
Complete switches with 1 cable entry

| Type of head | Plunger (fixing by the head) | | Rotary (fixing by the body) | | | | Multi-directional |
|------------------|------------------------------|-------------------------------|-----------------------------|--|-------------------------------------|---|---------------------|
| | Form A (1) | | | | | | |
| | | | | | | | |
| Type of operator | M18 with metal end plunger | M18 with steel roller plunger | Thermoplastic roller lever | Variable length thermoplastic roller lever | Thermoplastic roller lever, Ø 50 mm | Variable length thermoplastic roller lever, Ø 50 mm | "Cat's whisker" (2) |

| References of complete switches with 1 ISO M16 x 1.5 cable entry (3) | | | | | | | |
|--|--|--|--|--|--|--|---|
| | XCKP21H0P16 1.8 4.6(P) 0.9 5mm | XCKP21H2P16 3.1(A) 7.8(P) 0 1.5 mm | XCKP2118P16 25° 70°(P) 0 12° 90° | XCKP2145P16 25° 70°(P) 0 12° 90° | XCKP2139P16 25° 70°(P) 0 12° 90° | XCKP2149P16 25° 70°(P) 0 12° 90° | XCKP2106P16 20° 0 15° |
| | XCKP25H0P16 1.8 3.2(P) 0 3 5mm | XCKP25H2P16 3.1(A) 5.6(P) 0 0.5 2 mm | XCKP2518P16 25° 46°(P) 0 42° 90° | XCKP2545P16 25° 46°(P) 0 42° 90° | XCKP2539P16 25° 46°(P) 0 42° 90° | XCKP2549P16 25° 46°(P) 0 42° 90° | XCKP2506P16 20° 0 45° |
| | ZCP29 + ZCPEP16 + ZCEH0 1.8 4.6(P) 0.9 5mm | ZCP29 + ZCPEP16 + ZCEH2 3.1(A) 7.8(P) 0 1.5 mm | ZCP29 + ZCPEP16 + ZCE01 + ZCY18 25° 70°(P) 0 12° 90° | ZCP29 + ZCPEP16 + ZCE01 + ZCY45 25° 70°(P) 0 12° 90° | ZCP29 + ZCPEP16 + ZCE01 + ZCY39 25° 70°(P) 0 12° 90° | ZCP29 + ZCPEP16 + ZCE01 + ZCY49 25° 70°(P) 0 12° 90° | ZCP29 + ZCPEP16 + ZCE06 20° 0 15° |
| | ZCP27 + ZCPEP16 + ZCEH0 1.8 3.2(P) 0 5mm | ZCP27 + ZCPEP16 + ZCEH2 3.1 5.6(P) 0 mm | ZCP27 + ZCPEP16 + ZCE01 + ZCY18 25° 46°(P) 0 90° | ZCP27 + ZCPEP16 + ZCE01 + ZCY45 25° 46°(P) 0 90° | ZCP27 + ZCPEP16 + ZCE01 + ZCY39 25° 46°(P) 0 90° | ZCP27 + ZCPEP16 + ZCE01 + ZCY49 25° 46°(P) 0 90° | ZCP27 + ZCPEP16 + ZCE06 20° 0 |
| | ZCP39 + ZCPEP16 + ZCEH0 1.8 4.6(P) 0.9 5mm | ZCP39 + ZCPEP16 + ZCEH2 3.1(A) 7.8(P) 0 1.5 mm | ZCP39 + ZCPEP16 + ZCE01 + ZCY18 25° 70°(P) 0 12° 90° | ZCP39 + ZCPEP16 + ZCE01 + ZCY45 25° 70°(P) 0 12° 90° | ZCP39 + ZCPEP16 + ZCE01 + ZCY39 25° 70°(P) 0 12° 90° | ZCP39 + ZCPEP16 + ZCE01 + ZCY49 25° 70°(P) 0 12° 90° | ZCP39 + ZCPEP16 + ZCE06 20° 0 15° |
| | ZCP37 + ZCPEP16 + ZCEH0 1.8 3.2(P) 0 3 5mm | ZCP37 + ZCPEP16 + ZCEH2 3.1(A) 5.6(P) 0 0.5 2 mm | ZCP37 + ZCPEP16 + ZCE01 + ZCY18 25° 46°(P) 0 42° 90° | ZCP37 + ZCPEP16 + ZCE01 + ZCY45 25° 46°(P) 0 42° 90° | ZCP37 + ZCPEP16 + ZCE01 + ZCY39 25° 46°(P) 0 42° 90° | ZCP37 + ZCPEP16 + ZCE01 + ZCY49 25° 46°(P) 0 42° 90° | ZCP37 + ZCPEP16 + ZCE06 20° 0 45° |
| Weight (kg) | 0.130 | 0.130 | 0.135 | 0.145 | 0.145 | 0.155 | 0.085 |

References of complete switches with 1 entry for n° 11 cable gland

For an entry tapped for a n° 11 cable gland, replace P16 in the reference by G11. Example: XCKP21H0P16 becomes XCKP21H0G11 or ZCPEP16 becomes ZCPEG11.

Contact operation closed (A) = cam displacement NC contact with positive opening operation
 open (P) = positive opening point

| Characteristics | | | | | |
|-------------------------|--|--------------|---------------------|--|---------------------|
| Switch actuation | On end | By 30° cam | | | By any moving part |
| Type of actuation | | | | | |
| Maximum actuation speed | 0.5 m/s | 1.5 m/s | | | 1 m/s (any direct.) |
| Mechanical durability | 10 million operating cycles | | | | 5 million |
| Minimum force or torque | For tripping: 15 N For positive opening: 45 N | 10 N 36 N | 0.1 N.m 0.25 N.m | | 0.13 N.m - |
| Cable entry | 1 entry tapped M16 x 1.5 mm for ISO cable gland, clamping capacity 4 to 8 mm | | | | |

(1) Form conforming to EN 50047, see page 24.

(2) Value taken with actuation by moving part at 100 mm from the fixing.

(3) Switches with gold contacts or eyelet type connections: please consult our Customer Care Centre.

Limit switches

XC Standard range
Compact design, plastic, XCKP
Complete switches with 1 cable entry

ZCP2● + ZCPEP16/ZCP3● + ZCPEP16

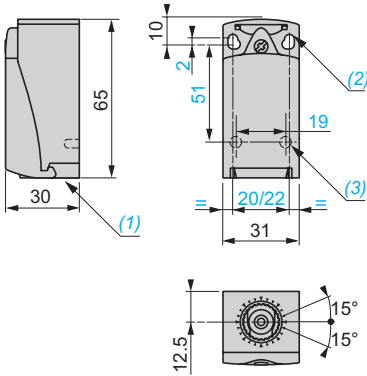

ZCE10

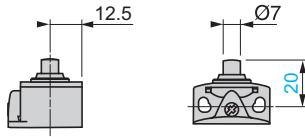

ZCE11

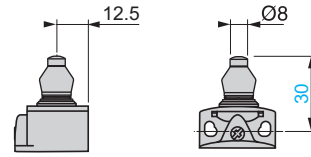

ZCE02

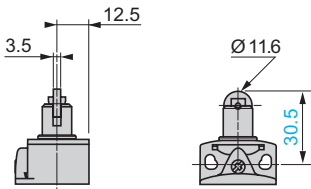

ZCE21

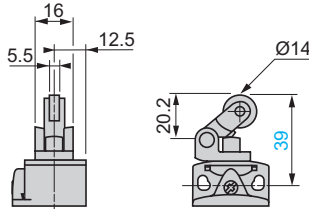

ZCE27

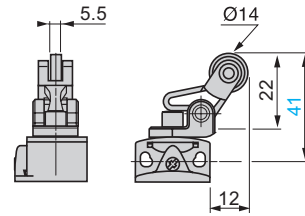

ZCE28

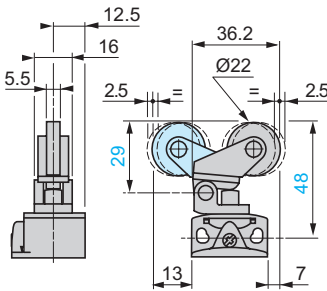

ZCEH0

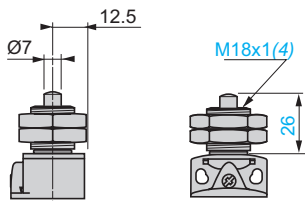

ZCEH2

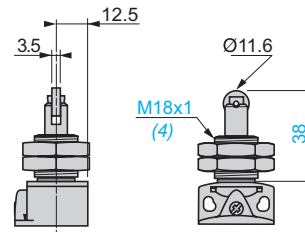

- (1) Tapped entry for ISO M16 x 1.5 or Pg 11 cable gland.
 (2) 2 elongated holes Ø 4.3 x 6.3 mm on 22 mm centres, 2 holes Ø 4.3 on 20 mm centres.
 (3) 2 x Ø 3 holes for support studs, depth 4 mm.
 (4) Fixing nut thickness 3.5 mm.

Limit switches

XC Standard range

Compact design, plastic, XCKP

Complete switches with 1 cable entry

ZCE01 + ZCY18

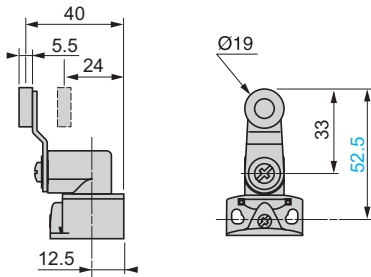

ZCE01 + ZCY45

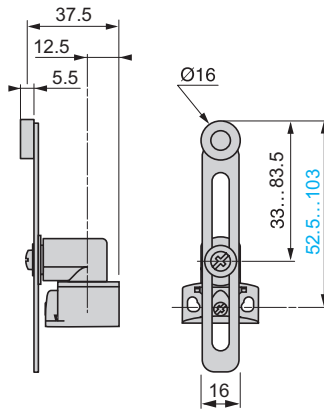

ZCE01 + ZCY39

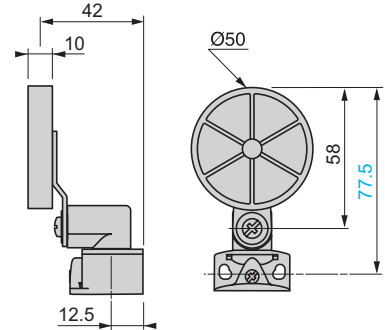

ZCE01 + ZCY49

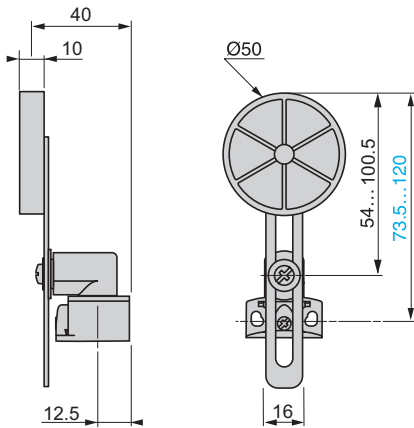

ZCE06

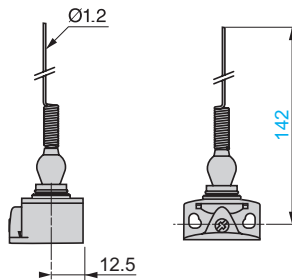

Limit switches

XC Standard range
Compact design, plastic, XCKP
M12 connector

| Type of head | Plunger (fixing by the body) | | | | | |
|------------------|------------------------------|---|----------------------|---|---|--|
| | Form B (1) | | Form C (1) | Form E (1) | | |
| | | | | | | |
| Type of operator | Metal end plunger | Metal end plunger with elastomer boot (2) | Steel roller plunger | Thermoplastic roller lever plunger, horizontal actuation in 1 direction | Thermoplastic roller lever plunger, vertical actuation in 1 direction | Thermoplastic roller lever plunger, horiz. or vert. actuation in 1 direction |

| References | | | | | | |
|--|------------------|------------------|--|------------------|--|------------------|
| 2-pole NC + NO snap action (XE2SP2151) | XCKP2110M12 | XCKP2111M12 | XCKP2102M12 | XCKP2121M12 | XCKP2127M12 | XCKP2128M12 |
| | | | | | | |
| 2-pole NC + NC snap action (XE2SP2141) | ZCP29M12 + ZCE10 | ZCP29M12 + ZCE11 | ZCP29M12 + ZCE02 | ZCP29M12 + ZCE21 | ZCP29M12 + ZCE27 | ZCP29M12 + ZCE28 |
| | | | | | | |
| Weight (kg) | 0.100 | 0.100 | 0.100 | 0.110 | 0.110 | 0.110 |
| Contact operation | closed open | | (A) (B) = cam displacement (P) = positive opening point | | ⊖ NC contact with positive opening operation | |

(1) Form conforming to EN 50047, see page 24.
(2) Nitrile for indoor use.

| Characteristics | | | |
|---|--|--------------|-------------|
| Switch actuation | On end | By 30° cam | |
| Type of actuation | | | |
| Maximum actuation speed | 0.5 m/s | | 1 m/s |
| Mechanical durability (in millions of operating cycles) | 15 | 10 | 15 |
| Minimum force or torque | For tripping: 15 N For positive opening: 45 N | 12 N 36 N | 6 N 18 N |
| Connection | M12 connector, U _i = 250 V, I _e = 3 A maximum, I _{th} = 3 A | | |

Connections

M12 connector

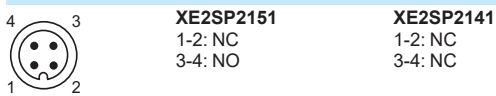

Dimensions

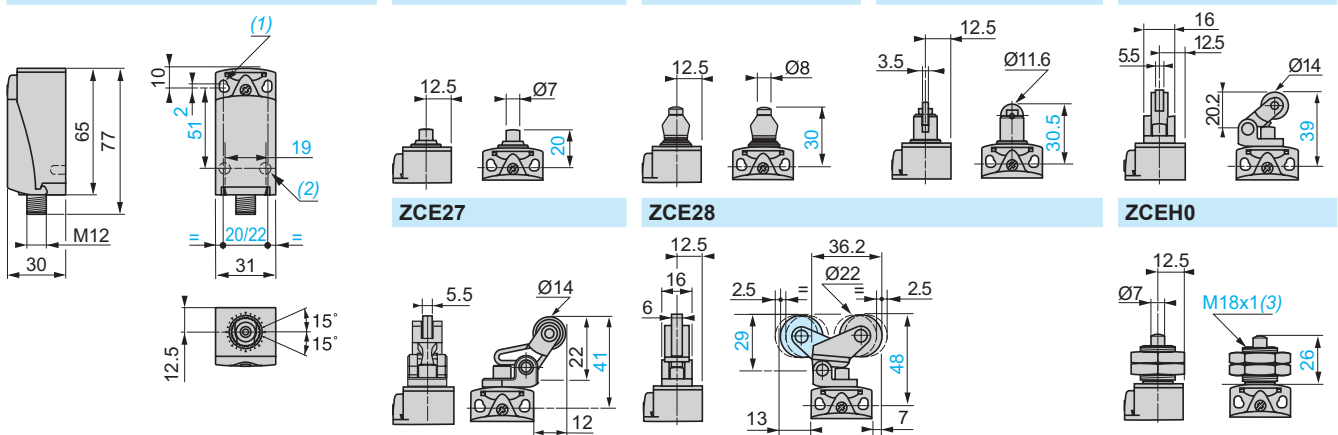

(1) 2 elongated holes Ø 4.3 x 6.3 mm on 22 mm centres, 2 holes Ø 4.3 on 20 mm centres.
(2) 2 x Ø 3 holes for support studs, depth 4 mm.
(3) Fixing nut thickness 3.5 mm.

Limit switches

XC Standard range
Compact design, plastic, XCKP
M12 connector

| Type of head | Plunger (fixing by the head) | Rotary (fixing by the body) | | | | | Multi-directional |
|------------------|------------------------------|-------------------------------|----------------------------|--|-------------------------------------|---|---------------------|
| | | Form A (1) | | | | | |
| | | | | | | | |
| Type of operator | M18 with metal end plunger | M18 with steel roller plunger | Thermoplastic roller lever | Variable length thermoplastic roller lever | Thermoplastic roller lever, Ø 50 mm | Variable length thermoplastic roller lever, Ø 50 mm | "Cat's whisker" (2) |

| References | | | | | | | | |
|--|--|------------------------|--|-----------------------------|--|-------------------------------------|-------------------------------------|-------------------------------------|
| 2-pole NC + NO snap action (XE2SP2151) | | XCKP21H0M12 | XCKP21H2M12 | XCKP2118M12 | XCKP2145M12 | XCKP2139M12 | XCKP2149M12 | XCKP2106M12 |
| | 2-pole NC + NC snap action (XE2SP2141) | | ZCP29M12 + ZCEH0 | ZCP29M12 + ZCEH2 | ZCP29M12 + ZCE01 + ZCY18 | ZCP29M12 + ZCE01 + ZCY45 | ZCP29M12 + ZCE01 + ZCY39 | ZCP29M12 + ZCE01 + ZCY49 |
| Weight (kg) | | 0.140 | 0.140 | 0.140 | 0.150 | 0.155 | 0.160 | 0.090 |
| Contact operation | closed open | | (A) = cam displacement (P) = positive opening point | | NC contact with positive opening operation | | | |

(1) Form conforming to EN 50047, see page 24.
(2) Value taken with actuation by moving part at 100 mm from the fixing.

| Characteristics | | | | | |
|---|--|------------|------|----------|---------------------|
| Switch actuation | On end | By 30° cam | | | By any moving part |
| Type of actuation | | | | | |
| Maximum actuation speed | 0.5 m/s | 1.5 m/s | | | 1 m/s (any direct.) |
| Mechanical durability (in millions of operating cycles) | 10 | | | | 5 |
| Minimum force or torque | For tripping | 15 N | 10 N | 0.1 N.m | 0.13 N.m |
| | For positive opening | 45 N | 36 N | 0.25 N.m | – |
| Connection | M12 connector, U _i = 250 V, I _e = 3 A maximum, I _{th} = 3 A | | | | |

Dimensions

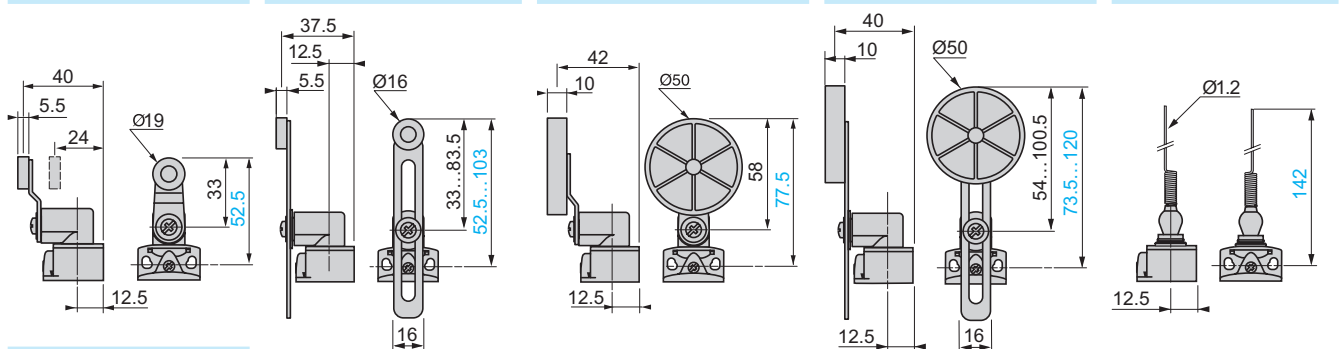

ZCEH2

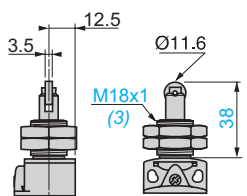

(3) Fixing nut thickness 3.5 mm.

Limit switches

XC Standard range

Compact design, XCKD, XCKP and XCKT
Variable composition

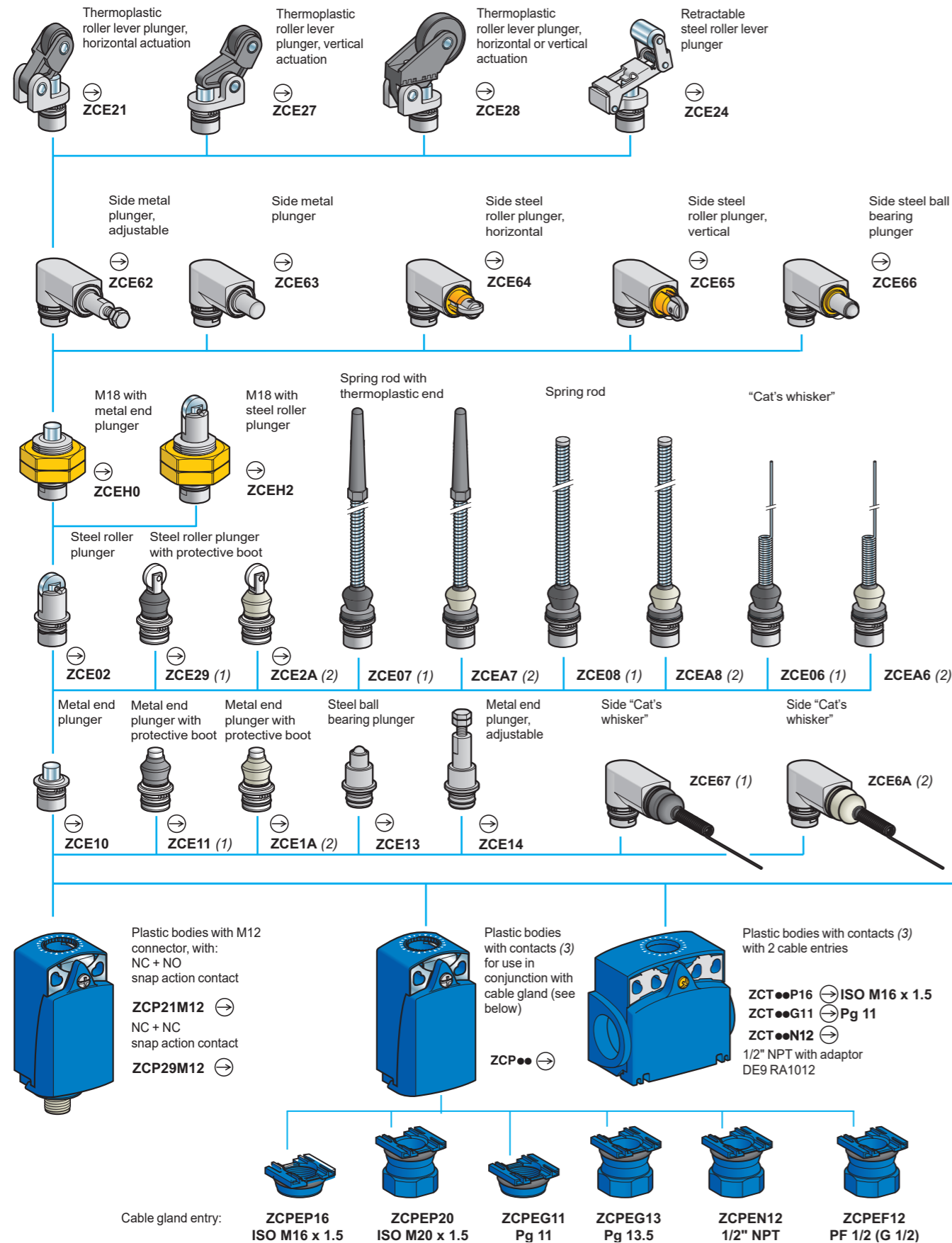

(1) Nitrile boot for indoor use.
(2) Silicone boot for outdoor use.
(3) For further information, see page 90.

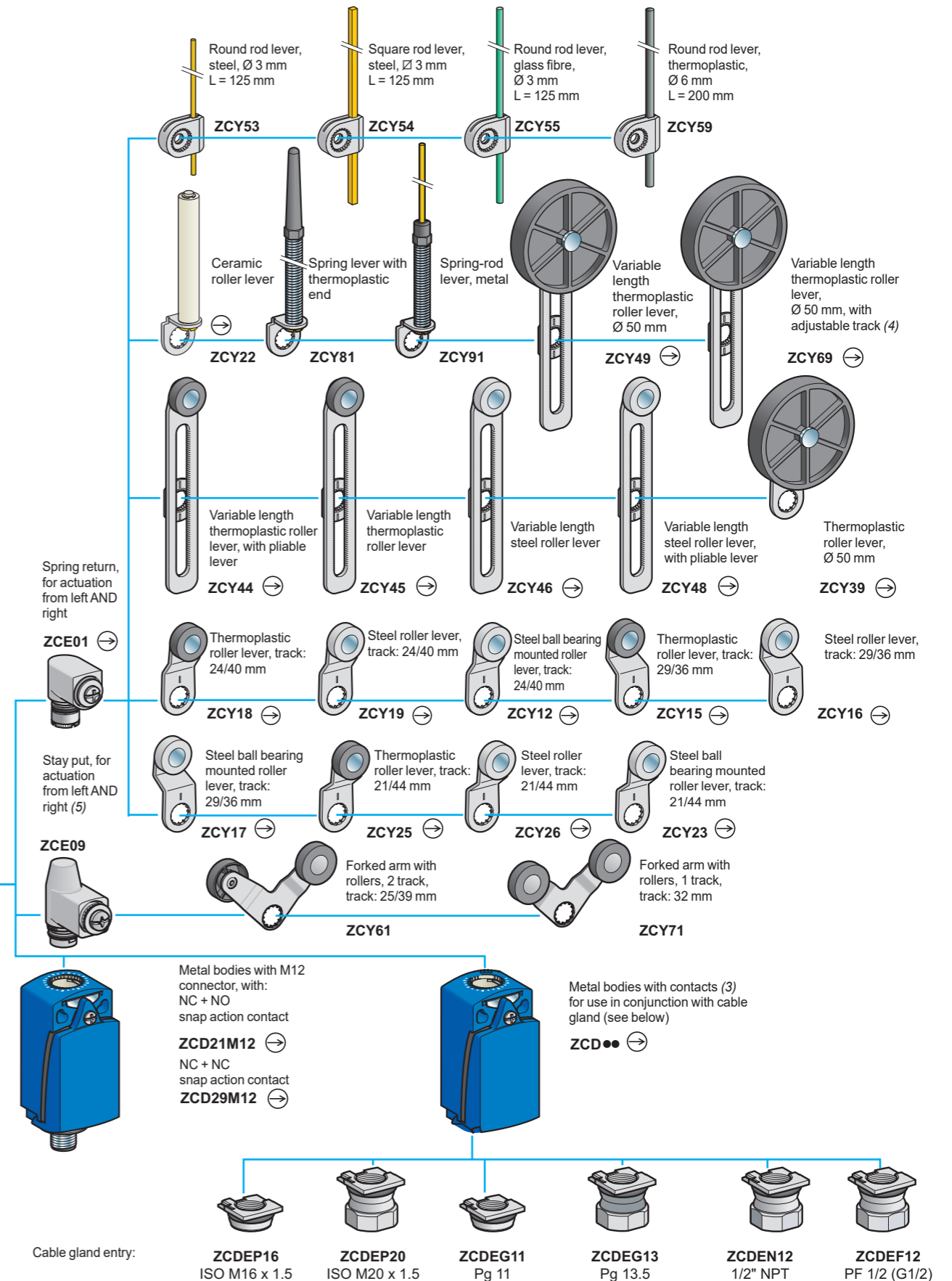

(4) Variable length and adjustable track by lever deformation.
(5) Suitable with bodies: ZCD21, ZCP21, ZCT21, ZCD29, ZCP29, ZCD31, ZCP31, ZCD39, ZCP39, ZCD2•M12, ZCP2•M12

Limit switches

XC Standard range
Compact design, metal, XCKD
or plastic, XCKP
Adaptable sub-assemblies: bodies with contacts

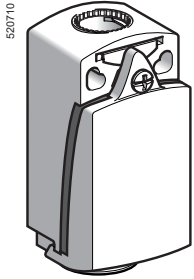

ZCD●●

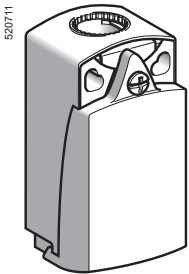

ZCP●●

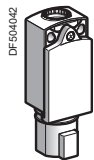

ZCP21D44

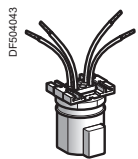

ZCPED44

Bodies with contacts, XCKD and XCKP (1)

| Type of contact | Positive operation (2) | Scheme | Body material | Reference | Weight kg |
|---|------------------------|--------|---------------|-----------|-----------|
| 2-pole | | | | | |
| NC + NO snap action (XE2SP2151) | ⊖ | | Metal | ZCD21 | 0.140 |
| | | | Plastic | ZCP21 | 0.070 |
| NC + NC snap action (XE2SP2141) | ⊖ | | Metal | ZCD29 | 0.140 |
| | | | Plastic | ZCP29 | 0.070 |
| NC + NO break before make, slow break (XE2NP2151) | ⊖ | | Metal | ZCD25 | 0.140 |
| | | | Plastic | ZCP25 | 0.070 |
| NO + NC make before break, slow break (XE2NP2161) | ⊖ | | Metal | ZCD26 | 0.140 |
| | | | Plastic | ZCP26 | 0.070 |
| NC + NC simultaneous, slow break (XE2NP2141) | ⊖ | | Metal | ZCD27 | 0.140 |
| | | | Plastic | ZCP27 | 0.070 |
| NO + NO simultaneous, slow break (XE2NP2131) | - | | Metal | ZCD28 | 0.140 |
| | | | Plastic | ZCP28 | 0.070 |
| 3-pole | | | | | |
| NC + NO + NO snap action (XE3SP2151) | ⊖ | | Metal | ZCD31 | 0.140 |
| | | | Plastic | ZCP31 | 0.070 |
| NC + NC + NO snap action (XE3SP2141) | ⊖ | | Metal | ZCD39 | 0.140 |
| | | | Plastic | ZCP39 | 0.070 |
| NC + NC + NO break before make, slow break (XE3NP2141) | ⊖ | | Metal | ZCD37 | 0.140 |
| | | | Plastic | ZCP37 | 0.070 |
| NC + NO + NO break before make, slow break (XE3NP2151) | ⊖ | | Metal | ZCD35 | 0.140 |
| | | | Plastic | ZCP35 | 0.070 |

Components for connection using DEUTSCH connector

Bodies with contacts for DEUTSCH connector

| Type of contact | Positive operation (2) | Scheme | Cable entry | Reference | Weight kg |
|---------------------------------------|------------------------|--------|-------------|-----------|-----------|
| 2-pole | | | | | |
| NC + NO snap action (XE2SP2151) | ⊖ | | Connector | ZCP21D44 | 0.065 |
| DEUTSCH male connector DT04-4P | | | | ZCPED44 | 0.015 |

(1) Bodies with gold contacts or eyelet type connections: please consult your Customer Care Centre.
(2) ⊖: bodies with contacts assuring positive opening operation.

Limit switches

XC Standard range

Compact design, metal, XCKD or plastic, XCKP and XCKT

Adaptable sub-assemblies: bodies with contacts

561127



ZCE05

561392

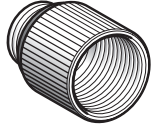

DE9RA1012

561388

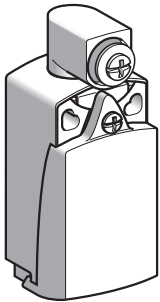

XCK2001

561389

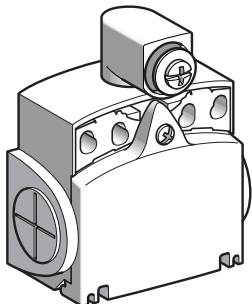

XCKT2001

Accessories

| Description | Suitable levers for use with head | Unit reference | Weight kg |
|---|---|----------------|-----------|
| Rotary head, without lever, spring return, for actuation from left AND right or left OR right (1) | ZCY12, ZCY15, ZCY16, ZCY17, ZCY18, ZCY19, ZCY22, ZCY23, ZCY25, ZCY26, ZCY39, ZCY53, ZCY54, ZCY55, ZCY81 | ZCE05 | 0.045 |
| Tap-off terminal for XCKT | Sold in lots of 10 | XALZ09 | 0.010 |
| Spacer for angular positioning of heads with adjustable levers, for values other than - 90°, 0° and 90° | – | XCMZ07 | 0.002 |
| Adaptor for 1/2" NPT conduit (male Pg 11 / female 1/2" NPT) | Sold in lots of 10 | DE9RA1012 | 0.050 |

Bodies with contacts, XCKP plastic, with rotary head (without operating lever)

| Type of contact | Scheme | Positive operation (2) | Cable entry | Reference | Weight kg |
|---|--------|------------------------|---------------|-------------|-----------|
| 2-pole | | | | | |
| NC + NO snap action (XE2SP2151) | | | ISO M16 x 1.5 | XCKP2101P16 | 0.115 |
| | | | Pg 11 | XCKP2101G11 | 0.115 |
| | | | M12 connector | XCKP2101M12 | 0.125 |
| NC + NO break before make, slow break (XE2NP2151) | | | ISO M16 x 1.5 | XCKP2501P16 | 0.115 |
| | | | Pg 11 | XCKP2501G11 | 0.115 |

Bodies with contacts, XCKD metal, with rotary head (without operating lever)

| Type of contact | Scheme | Positive operation (2) | Cable entry | Reference | Weight kg |
|---|--------|------------------------|---------------|-------------|-----------|
| 2-pole | | | | | |
| NC + NO snap action (XE2SP2151) | | | ISO M16 x 1.5 | XCKD2101P16 | 0.185 |
| | | | Pg 11 | XCKD2101G11 | 0.185 |
| | | | M12 connector | XCKD2101M12 | 0.195 |
| NC + NO break before make, slow break (XE2NP2151) | | | ISO M16 x 1.5 | XCKD2501P16 | 0.185 |
| | | | Pg 11 | XCKD2501G11 | 0.185 |

Bodies with contacts, XCKT plastic, with rotary head (without operating lever)

| Type of contact | Scheme | Positive operation (2) | Cable entry | Reference | Weight kg |
|---|--------|------------------------|---------------|-------------|-----------|
| 2-pole | | | | | |
| NC + NO snap action (XE2SP3151) | | | ISO M16 x 1.5 | XCKT2101P16 | 0.130 |
| | | | Pg 11 | XCKT2101G11 | 0.130 |
| NC + NO break before make, slow break (XE2NP3151) | | | ISO M16 x 1.5 | XCKT2501P16 | 0.130 |
| | | | Pg 11 | XCKT2501G11 | 0.130 |

(1) For programming see page 18.

(2) : bodies with contact assuring positive opening operation.

Limit switches

XC Standard range

Compact design, metal, XCKD or plastic, XCKP and XCKT

Adaptable sub-assemblies: contact blocks

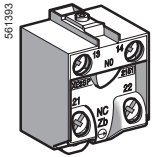

XE2●●21●●

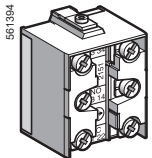

XE3●●21●●

Contact blocks with screw clamp terminals for XCKD and XCKP

| Type of contact | Positive operation (1) | Scheme | Reference for standard contacts | Weight kg |
|--|------------------------|--------|---------------------------------|-----------|
| 2-pole | | | | |
| NC + NO snap action | ⊕ | | XE2SP2151 | 0.020 |
| NC + NC simultaneous, snap action | ⊕ | | XE2SP2141 | 0.020 |
| NC + NO break before make, slow break | ⊕ | | XE2NP2151 | 0.020 |
| NO + NC make before break, slow break | ⊕ | | XE2NP2161 | 0.020 |
| NC + NC simultaneous, slow break | ⊕ | | XE2NP2141 | 0.020 |
| NO + NO simultaneous, slow break | - | | XE2NP2131 | 0.020 |
| 3-pole | | | | |
| NC + NO + NO snap action | ⊕ | | XE3SP2151 | 0.035 |
| NC + NC + NO snap action | ⊕ | | XE3SP2141 | 0.035 |
| NC + NC + NO break before make, slow break | ⊕ | | XE3NP2141 | 0.035 |
| NC + NO + NO break before make, slow break | ⊕ | | XE3NP2151 | 0.035 |

Contact blocks with screw clamp terminals for XCKT

| Type of contact | Positive operation (1) | Scheme | Reference for standard contacts | Weight kg |
|---------------------------------------|------------------------|--------|---------------------------------|-----------|
| 2-pole | | | | |
| NC + NO snap action | ⊕ | | XE2SP3151 | 0.015 |
| NC + NO break before make, slow break | ⊕ | | XE2NP3151 | 0.015 |
| NO + NC make before break, slow break | ⊕ | | XE2NP3161 | 0.015 |
| NC + NC simultaneous, slow break | ⊕ | | XE2NP3141 | 0.015 |
| NO + NO simultaneous, slow break | - | | XE2NP3131 | 0.015 |

(1) ⊕: contact blocks assuring positive opening operation.